

Consulting Engineer's Certification:
 I, hereby certify that the As Constructed information shown on the plan is a true and correct record of the sizes, types, materials, classes etc., and it corresponds with the relevant approved Engineering Drawings.
 Signed..... RPEQ No..... Dated.....

REGISTERED CADASTRAL SURVEYOR (QLD) CERTIFICATION:
 LandPartners Pty Ltd, hereby certify that the horizontal and vertical locations, and dimensions shown on this plan are a true and correct record of the As Constructed information.
R. G. Andrew 4118 24/02/2025
 Authorised Delegate Rego No. Date
 LandPartners Pty Ltd
 Registered Qld Surveyor Corporation

CLIENT
ORCHARD (PEBBLE CREEK) DEVELOPMENTS PTY LTD
 PROJECT
AS CONSTRUCTED STORMWATER PEBBLE CREEK STAGE 11 DEV 2017 / 887

NOTES
 - ALL STORMWATER PIPES ARE RCP CLASS '3' U.N.O.
 - ALL STORMWATER PIPES ARE Ø375 U.N.O.

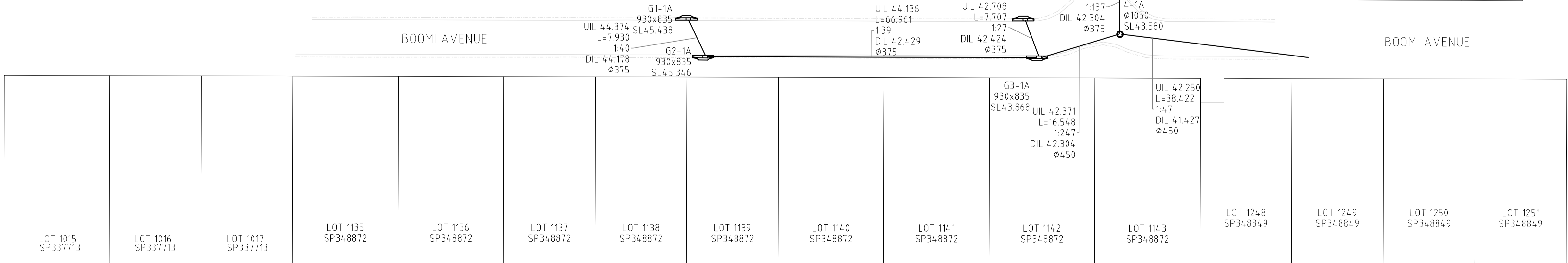
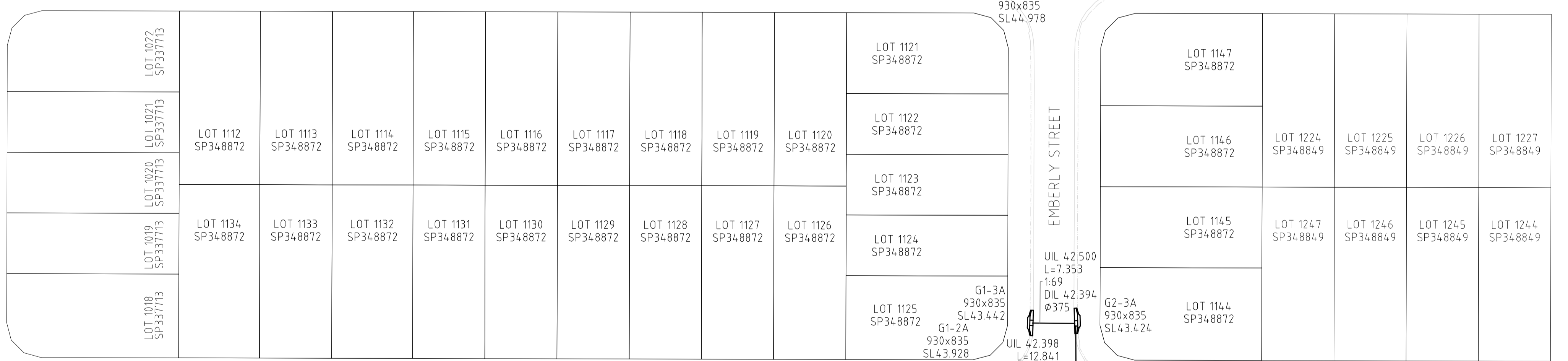
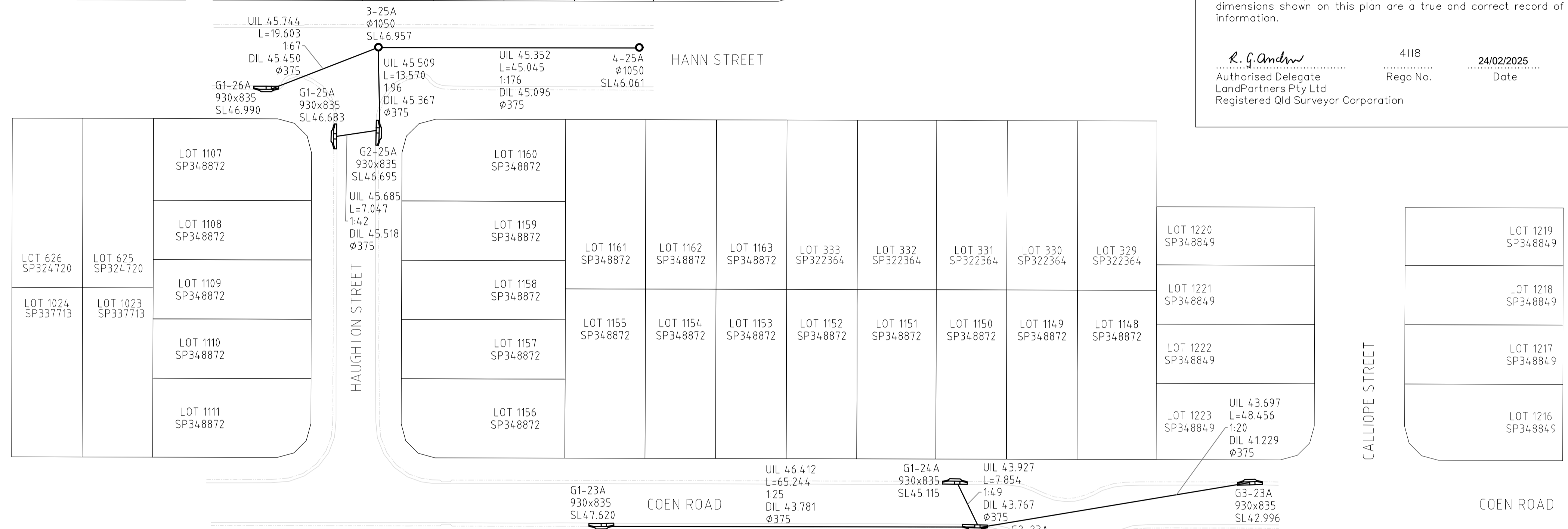

ENGINEERING FIRM:
COLLIERS ENGINEERING & DESIGN PTY LTD

REV	DATE	DRAWN	CHECKED	APPROVED	SURVEY DATE
2	24/02/2025	MJK	RA	RA	13/02/2025
1	20/02/2025	MJK	RA	RA	13/02/2025



Brisbane Office Level 1 18 Little Cribb Street Milton QLD 4064
 PO Box 1399 Milton QLD 4064
 p: (07) 3842 1000 f: (07) 3842 1001 info@landpartners.com.au www.landpartners.com.au

LEVEL DATUM	AHD	LOCAL AUTHORITY	LOGAN C.C.
LEVEL ORIGIN	-	CONTOUR INTERVAL	-
MERIDIAN	MGA2020	CO-ORD SYSTEM	MGA ZONE 56

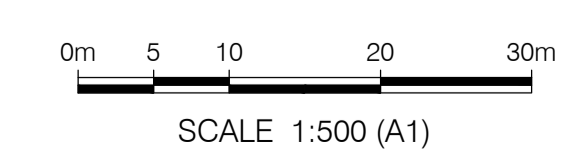

UDN
BRSS7455-011-81-2
 SHEET 1 OF 1