

Consulting Engineer's Certification:

I, ..... hereby certify that the As Constructed information shown on the plan is a true and correct record of the sizes, types, materials, classes etc., and it corresponds with the relevant approved Engineering Drawings.

Signed..... RPEQ No..... Dated.....

---

REGISTERED CADASTRAL SURVEYOR (QLD) CERTIFICATION:

LandPartners Pty Ltd, hereby certify that the horizontal and vertical locations, and dimensions shown on this plan are a true and correct record of the As Constructed information.

Signed *R. G. Anderson*..... Date 21/08/2024.....  
(Authorised Delegate)

LandPartners Pty Ltd, Registered Cadastral Surveyor SBQ ID 4118

CLIENT

**ORCHARD (PEBBLE CREEK) DEVELOPMENTS PTY LTD**

PROJECT

**AS CONSTRUCTED STORMWATER**  
PEBBLE CREEK STAGE 13  
DEV 2017 / 887

NOTES

- STORMWATER MANHOLE 18-1A HAS A SURFACE LEVEL FROM DESIGN.
- ALL STORMWATER PIPES ARE RCP CLASS '3' U.N.O.
- ALL ROOFWATER PIPES ARE Ø150 PVC-U CLASS '8' U.N.O.

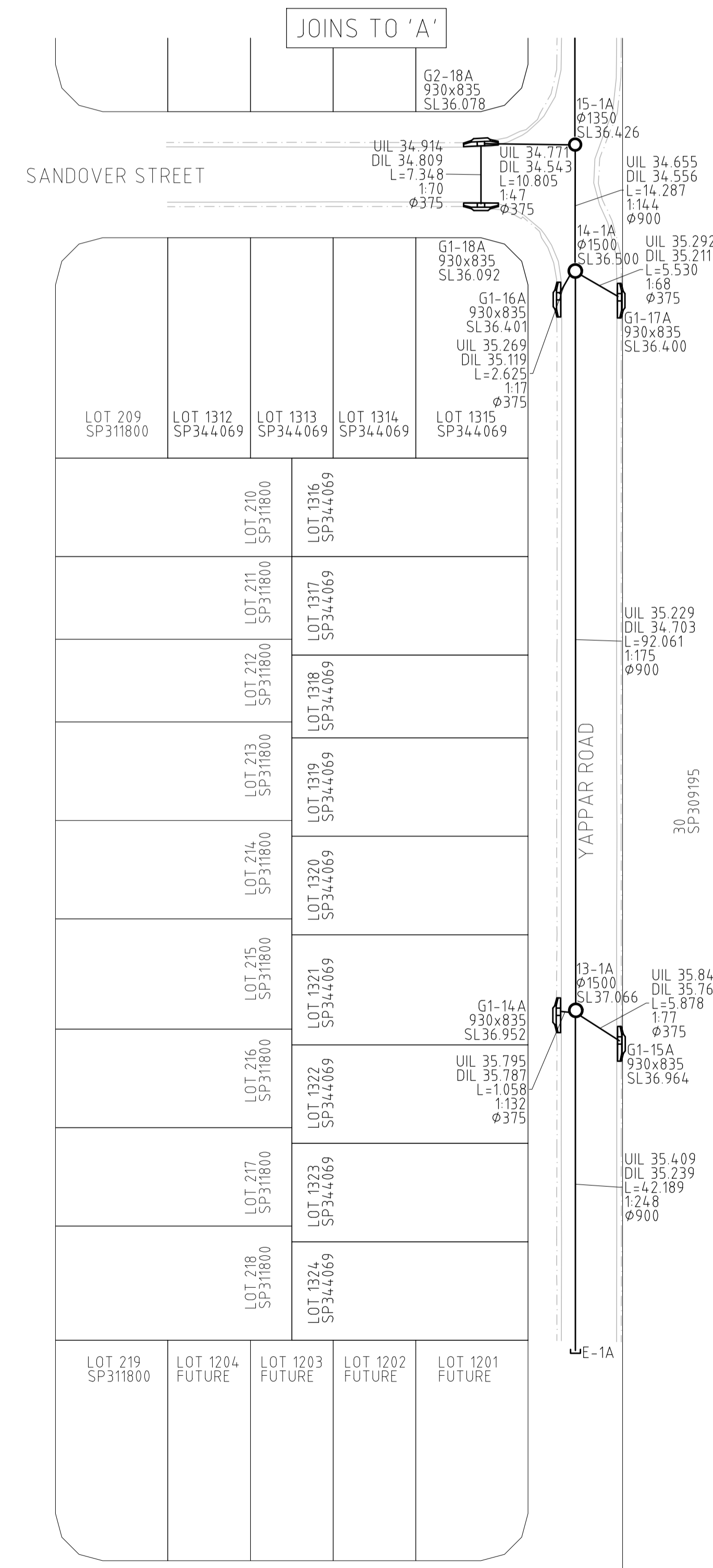

PEBBLE CREEK WAY

HANN STREET

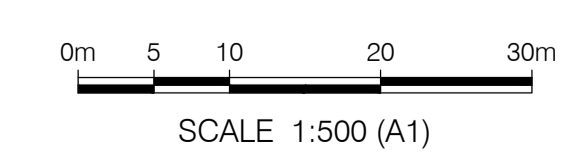

REV	DATE	DRAWN	CHECKED	APPROVED	APPROVAL DATE
1	21/08/2024	BJB	RA	RA	21/08/2024

Brisbane Office  
Level 1  
18 Little Cribb Street  
Milton QLD 4064

PO Box 1399  
Milton  
QLD 4064

p: (07) 3842 1000  
f: (07) 3842 1001  
e: info@landpartners.com.au  
w: www.landpartners.com.au

LEVEL DATUM	AHD	LOCAL AUTHORITY	LOGAN C.C.
LEVEL ORIGIN	-	CONTOUR INTERVAL	N/A
MERIDIAN	MGAS94	CO-ORD SYSTEM	MGA ZONE 56

UDN

**BRSS7455-013-42-1**

SHEET 1 OF 1

©LANDPARTNERS 2024