

LEGEND

- (FH) FIRE HYDRANT
- ⊗ (VS) STOP VALVE
- (TB) TAPPING BAND
- × (WM) WATER METER (SEQ 20φ)
- ┌ END CAP
- └ TEE
- BEND
- DI CL WATER MAIN CROSSING
- ==== CONDUIT/CROSSING
- EXISTING WATER

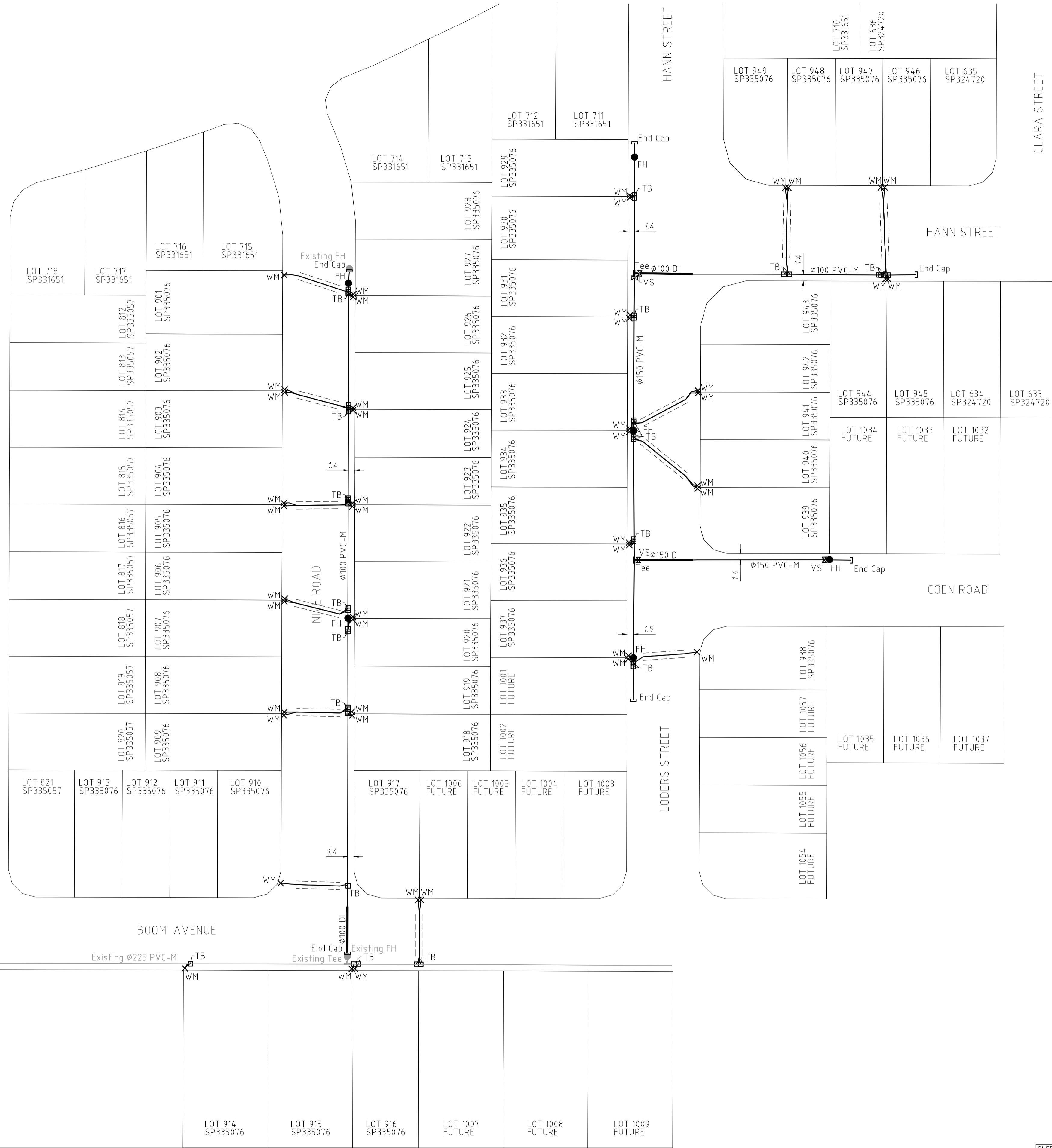
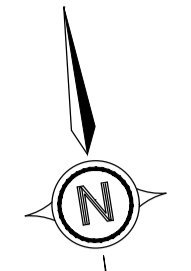

NOTES

- ALL WATER MAIN PIPES ARE PVC-M PN16 U.N.O.
- ALL WATER MAIN CROSSING PIPES ARE DI CL PN35 U.N.O.
- ALL FIRE HYDRANTS ARE φ100 SPRING U.N.O.
- ALL SERVICE CROSSING CONDUITS ARE φ100 uPVC PN9 U.N.O.

**Works As Constructed**

It is certified that the locations, Levels and dimensions of the infrastructure shown herein are a true representation of the constructed works and that the As-Constructed survey was performed to the prescribed accuracy standards.

Authorised Delegate: *C. Walters*

Date: 18/08/2023

LandPartners Pty Ltd (ACN 118 146 008) Surveyor No. S4118

**Works As Constructed**

It is certified that works herein have been constructed to Local Government standards, relevant approved specifications and the operational works approval. The As-Constructed Drawings for these works constitutes a true and correct record of the works constructed and complies with the design intent.

Signature: *[Signature]* RPEQ No. 20631

Date of Practical Completion: 22/06/2023

Engineering Consultant: **Troy Schultz**

A1

ISSUE	DATE	AUTHOR	COMMENTS	ISSUE	DATE	AUTHOR	COMMENTS
1	18/08/2023	MJK	INITIAL ISSUE				

**LANDPARTNERS**  
surveyors and planners

Brisbane Office  
Level 11  
18 Little Crebb Street  
Milton Qld 4064  
PO Box 1399  
Milton Qld 4064

Phone: (07) 5842 1000  
Email: info@landpartners.com.au  
Website: www.landpartners.com.au

CLIENT  
**ORCHARD (PEBBLE CREEK) DEVELOPMENTS PTY LTD**

PROJECT  
**PEBBLE CREEK STAGE 9  
AS CONSTRUCTED WATER  
DEV2017/887**

ENGINEERING CONSULTANT  
**COLLIERS ENGINEERING & DESIGN PTY LTD**

LGA/SERVICE PROVIDER  
**ECONOMIC DEVELOPMENT QUEENSLAND**

SCALE 1:500

SHEET		
1 of 1		
DATUM	AHD	LEVEL ORIGIN
CONTOURS	N/A	FILE NO. BRSS7455-009-62-1
DRAWN	MJK	DATE 18/08/2023
CHECKED	VO	DATE 18/08/2023
APPROVED	CGW	DATE 18/08/2023
PLAN NUMBER		BRSS7455-009-64-1