

LEGEND

- (FH) FIRE HYDRANT
- ⊗ (VS) STOP VALVE
- ⊗ (VA) SCOUR ASSEMBLY
- (TB) TAPPING BAND
- ⊗ (WM) WATER METER (SEQ 20φ)
- ┌ END CAP
- └ TEE
- > REDUCER
- BEND
- DICL WATER MAIN CROSSING
- - - CONDUIT/CROSSING
- EXISTING WATER

LOT 131 SP309239	LOT 132 SP309239	LOT 133 SP309239	LOT 134 SP309239	LOT 135 SP309239	LOT 136 SP309239
LOT 137 SP309239	LOT 138 SP309239	LOT 139 SP309239	LOT 140 SP309239	LOT 141 SP309239	LOT 142 SP309239
LOT 143 SP309239	LOT 144 SP309239	LOT 145 SP309239	LOT 146 SP309239	LOT 147 SP309239	LOT 148 SP309239
LOT 149 SP309239	LOT 150 SP309239	LOT 151 SP309239	LOT 152 SP309239	LOT 153 SP309239	LOT 154 SP309239

NOTES

- ALL WATER METERS ARE AS PER DESIGN
- ALL FIRE HYDRANTS ARE φ100 SPRING U.N.O.
- ALL WATER MAIN PIPES ARE PVC-M PN16 U.N.O.
- ALL WATER MAIN CROSSING PIPES ARE DICL PN35 U.N.O.
- ALL SERVICE CROSSING CONDUITS ARE φ100 uPVC PN9 U.N.O.

Works As Constructed

It is certified that the locations, Levels and dimensions of the infrastructure shown herein are a true representation of the constructed works and that the As-Constructed survey was performed to the prescribed accuracy standards.

Authorised Delegate.....*Rosa McDowall*.....(DIRECTOR)
 Date.....20/12/2019.....
 LandPartners Pty Ltd (ACN I18 146 008) Surveyor No. S4118

Works As Constructed

It is certified that works herein have been constructed to Local Government standards, relevant approved specifications and the operational works approval. The As-Constructed Drawings for these works constitutes a true and correct record of the works constructed and complies with the design intent.

Signature.....RPEQ No.....
 Date of Practical Completion.....
 Engineering Consultant.....

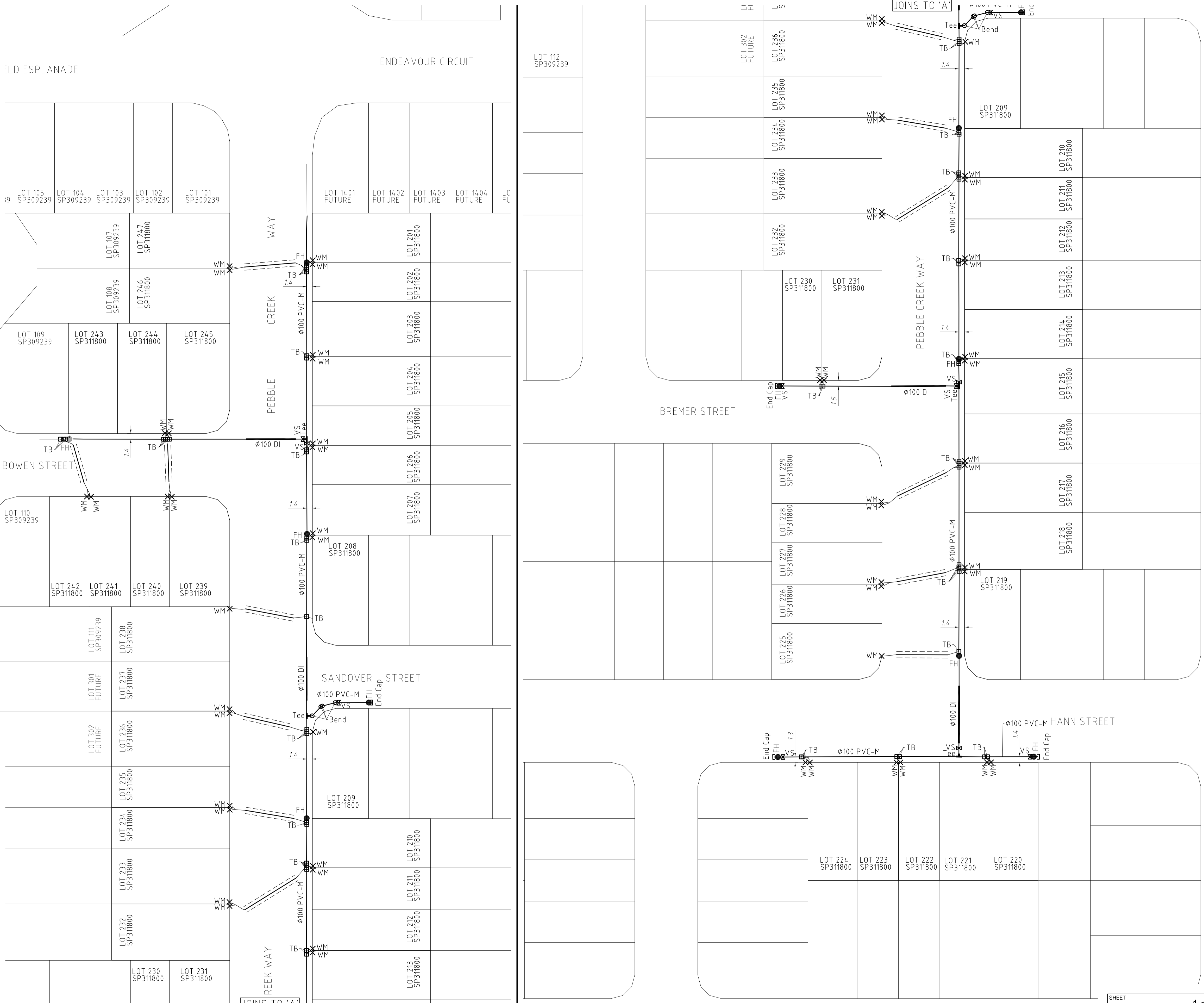

A1

ISSUE	DATE	AUTHOR	COMMENTS	ISSUE	DATE	AUTHOR	COMMENTS
1	09/12/2019	BJB	INITIAL ISSUE				
2	20/12/2019	BJB	VALVES ADDED				



Brisbane Office
 Level 1,
 28 Little Collins Street,
 Milton, QLD, 4064
 PO Box 1399
 1 (07) 3842 1000
 e info@landpartners.com.au
 www.landpartners.com.au

CLIENT **ORCHARD DEVELOPMENTS PTY LTD**

PROJECT **PEBBLE CREEK STAGE 2 AS CONSTRUCTED WATER DEV2017/887/23**

ENGINEERING CONSULTANT **PEAK URBAN PTY LTD**

LGA/SERVICE PROVIDER **ECONOMIC DEVELOPMENT QUEENSLAND**

SCALE 1:500

SHEET 1 of 1		
DATUM	AHD	LEVEL ORIGIN
CONTOURS	N/A	FILE NO. BRSS7455-002-56-2
DRAWN	BJB	DATE 20/12/2019
CHECKED	RA	DATE 20/12/2019
APPROVED	RA	DATE 20/12/2019
PLAN NUMBER	BRSS7455-002-58-2	